

Roller Shade

Clutch Roller Installation Instructions

IMPORTANT! Roller shade brackets must be LEVEL for the shade to operate properly.

Cassette Headrail:

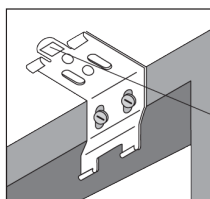

For WALL or OUTSIDE mounts, use the rear bracket holes. Make sure the release tab is always mounted on the top.

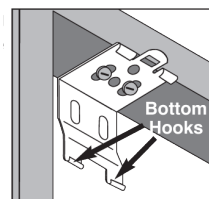

For INSIDE or CEILING mounts, use the top bracket holes. Make sure the release tab is always mounted on the top.

Mount the headrail.

Position the headrail with the back panel (A) resting on both bottom hooks of all the brackets. Push the front of the headrail firmly upwards and toward the window until the groove at the top of the headrail snaps into place (B) as shown.

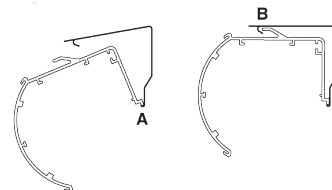

Square Fascia:

Mount the Brackets:

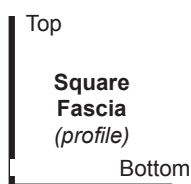

1. The open end of each bracket faces downward.
Note: If you have an inside mount and must use “end mount holes”, you will have to drill your own holes in the side of the bracket. Use at least two screws per brackets, and make sure that the screw heads clear the clutch mechanism. Install the brackets.

1a. Hold the mounting bracket in position in the window and mark the location where the first 2 screws should be positioned (diagonally). Then partially screw in both screws where marked with appropriate anchoring system.

1b. Slip the mounting bracket over the two screws and slide the bracket sideways until the screw heads capture the bracket. Fully tighten these screws. Install additional screws if needed.

Note that brackets can be used for an outside mount or inside mount (top, side or back).

2a. Install shade per your normal process (generally pin end into one bracket first, then compress slightly as you hook Skyline clutch hooks securely into center slots on facing bracket). Then adjust the shade position as desired.

3a. Insert tab of the clip into the bottom hole in the bracket as shown.

3b. With your thumb, push until you hear a click (see arrow).

Hook the fascia from the top of each bracket.

4c. Gently press fascia down and snap into the fascia clip at the bottom of the bracket.

Fascia Bracket

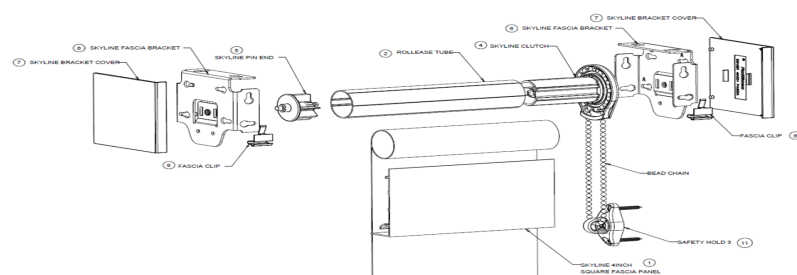
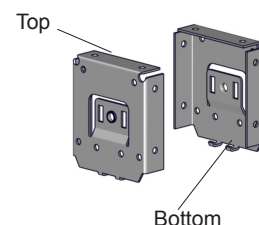

Cordless Lift

Follow Cassette Headrail Instructions

The lift tension has been preset at the factory. Adjustment is only needed if you have a different preference.

Use a large blade screw driver so you do not strip the adjustment screw. Raise the shade to the upper stop limit. Remove the cassette from the brackets if left side of shade is not accessible. Remove the left side cassette end cap to expose the lift tension screw. To increase the tension, lower the shade about 6" then rotate the adjustment screw clockwise. To decrease the tension rotate the adjustment screw counter-clockwise.

There must be enough tension or the shade will not reach the upper stop limit.

Raise the shade to the full up position and reinstall the cassette end cap and install the cassette back into the mounting brackets.

Tension adjustments may be made by using a standard screwdriver with the side-adjust bracket.

NOTE: Cordless shades should be installed on windows where the consumer can comfortably reach the shade hem to raise and lower.

Multiple shades mounted side-by-side may not “stop” at the exact same height when installed. However, “stop” adjustments can be made. Set the Stop Device to the desired stop position by using a standard screwdriver with the side-adjust bracket.

Inside mount shades must be uninstalled to make adjustments.

To adjust stop, turn counter clockwise to raise and turn clockwise to lower.

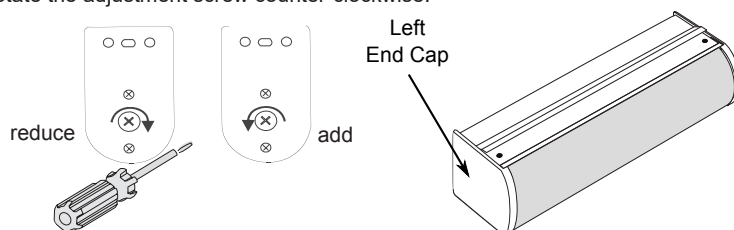

Deco Valance

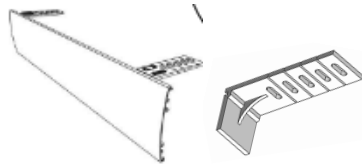

1. Install the valance brackets

The magnet clips arrive attached and evenly spaced to the Deco Valance.

2. Install the roller shade brackets.

Note: Do not attach the Deco Fascia until the shade has been installed

3. Install the shade.

4. Install the Deco Valance.

- For Inside mount attach magnets to magnet receiver
- For Outside mount attach magnets to magnet receiver and slide bracket into groove on bracket receiver

5. Install returns

- Metal returns (Outside mount only) include a plastic corner connector.
- Plastic returns (Inside mount with Outside Mounted fascia) snap on the end of the fascia.

If shade was ordered as outside mount (OB), attach the supplied screw covers on to the bracket for a finished look.

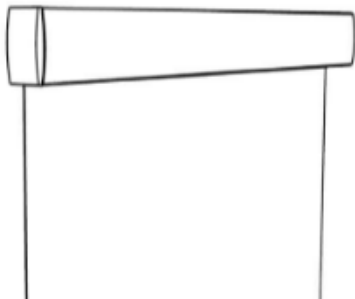

Step 1: Install valance brackets

Inside Mount



Outside Mount



Step 2: Install roller shade brackets

Step 3: Install the shade

Step 4: Install Inside Mount

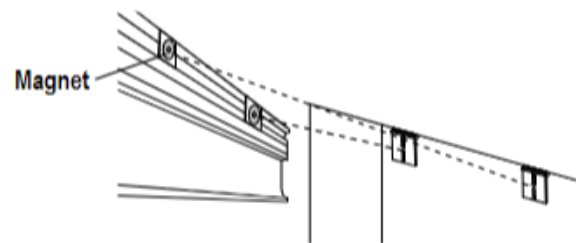

Step 4b: Install Outside Mount

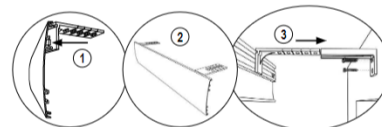

Step 5: Install outside mount returns

